

*HIGH SPEED
COMBINATION
BEARING
CG Series*

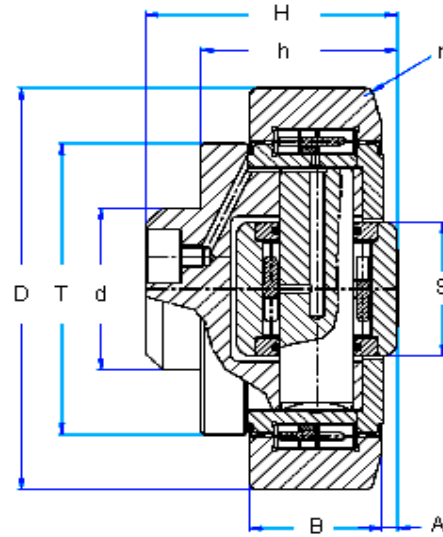

Part Number	d mm	T mm	D mm	H mm	h mm	B mm	A mm	S mm	r mm	C KN	Co KN	Ca KN	Coa KN
CG4.235-89	45	59	88.9	57	44	30	3.5	26	3	46.6	50	26	32.2
CG4.227-108	60	71	107.7	69	55	31	4	34	5	76	90	30	32
CG4.228-123	60	80	123	72.3	56	37	5	40	5	106	120	42	46
CG4.229-149	60	108	149	86	67	45	5	50	3	129	180	62	70
CG4.230-185	80	120	185	90.5	76	55	7	65	7.5	170	250	80	104

C	Dynamic Load
Co	Static Load
Ca	Axial Dynamic Load
Coa	Axial Static Load

NOTE:	<p>Dead load capacity variation with reference to working temperature.</p> <p>T ≤ 150° C=Co</p> <p>T150° ÷ 200° C=0,88Co</p> <p>T200° ÷ 250° C=0,71Co</p> <p>Radial clearance C3</p> <p>Sealing rings made of Viton(R) "OR"</p> <p>(Viton(R) is a registered trademark of DuPont Dow Elastomers)</p>
-------	--