

Workrolls ♦ Backup Rollers  
Cylindrical Roller Bearings

## SIMPLE BACKUP ROLLERS

Outside Diameters  
48mm to 122.5mm

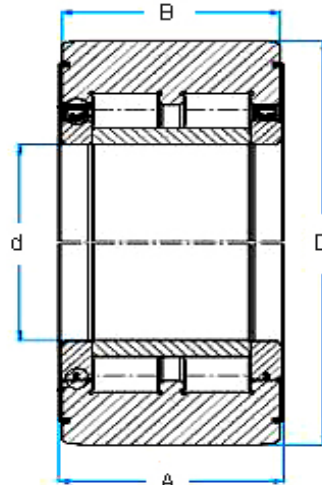

| Part Number | d mm | D mm  | A mm | B mm | C KN  | Co KN | Max RPM |
|-------------|------|-------|------|------|-------|-------|---------|
| 9.1907      | 20   | 48    | 36   | 27   | 36    | 53    | 1935    |
| 9.1867      | 25   | 52    | 42   | 40   | 38    | 60    | 1730    |
| 9.2161      | 25   | 52    | 48   | 46   | 38.6  | 60    | 1730    |
| 9.1857      | 25   | 65    | 45   | 41   | 68    | 95    | 1210    |
| 9.2160      | 25   | 65    | 45   | 41   | 78    | 111   | 1460    |
| 2.1077      | 30   | 72    | 42   | 40   | 73    | 105   | 1280    |
| 9.2323      | 30   | 72    | 42   | 40   | 70    | 100   | 1280    |
| 2.1741      | 25   | 74    | 50   | 47   | 99    | 139   | 1370    |
| 2.1031      | 40   | 80    | 33   | 31   | 39.5  | 32    | 3570    |
| 2.1721      | 35   | 80    | 54   | 50   | 103   | 163   | 1150    |
| 2.1197      | 35   | 80    | 48   | 44   | 100   | 161   | 1100    |
| 9.2169      | 30   | 80    | 48   | 44   | 85    | 141   | 1150    |
| 2.0059      | 40   | 90    | 35   | 32   | 57    | 62    | 850     |
| 9.2415      | 40   | 90    | 47   | 44   | 104   | 160   | 1000    |
| 9.2585      | 30   | 90    | 51   | 49   | 105   | 150.5 | 1200    |
| 9.2587      | 40   | 90    | 51   | 48   | 100   | 152   | 1000    |
| 9.2030      | 40   | 95    | 55   | 51   | 124   | 192   | 710     |
| 2.1193      | 45   | 100   | 40   | 37   | 85.5  | 76    | 900     |
| 9.2582      | 40   | 100   | 50   | 47   | 132   | 196   | 950     |
| 2.1198      | 50   | 105   | 60   | 56   | 189   | 314   | 850     |
| 9.2296      | 40   | 105   | 50   | 46   | 138   | 210   | 880     |
| 2.1352      | 45   | 110   | 60   | 56   | 200   | 340   | 800     |
| 2.1537      | 45   | 110   | 60   | 56   | 155   | 232   | 900     |
| 9.2204      | 35   | 114   | 54   | 52   | 132.5 | 196   | 980     |
| 9.2168      | 50   | 118   | 50   | 47   | 138   | 153   | 600     |
| 2.1249      | 50   | 120   | 58   | 55   | 161   | 245   | 800     |
| 2.1711      | 50   | 120   | 65   | 60   | 147   | 230   | 810     |
| 9.2012      | 50   | 120   | 70   | 66   | 231   | 390   | 816     |
| 2.0699      | 50   | 120   | 50   | 47   | 156   | 270   | 700     |
| 9.2352      | 55   | 120   | 52   | 49   | 156   | 270   | 700     |
| 9.2374      | 45   | 120   | 58   | 55   | 161   | 245   | 800     |
| 9.2423      | 50   | 120   | 68   | 65   | 176   | 264   | 800     |
| 2.1384      | 55   | 122   | 56   | 53   | 168   | 261   | 770     |
| 9.2018      | 55   | 122   | 56   | 52   | 152   | 240   | 780     |
| 2.0837      | 70   | 122.5 | 32   | 30   | 128   | 200   | 670     |

TECOM Inc.

205 St. George Street, Unit 5, Lindsay, Ontario, Canada

T: 705 878 3650 – F: 705 878 5019

[www.crbearing.com](http://www.crbearing.com)